

WORKING SAFELY IN YOUR BIOLOGICAL SAFETY CABINET

DO NOT CONFUSE LAMINAR FLOW CABINETS WITH BIOSAFETY CABINETS



Laminar flow cabinets can look very similar to biosafety cabinets, but they only protect samples inside the work zone from external airborne contamination. They do not protect the operator. Read the labeling on your cabinet carefully before proceeding.

DO NOT USE THE CABINET FOR AGENTS OF EXTREME HAZARD

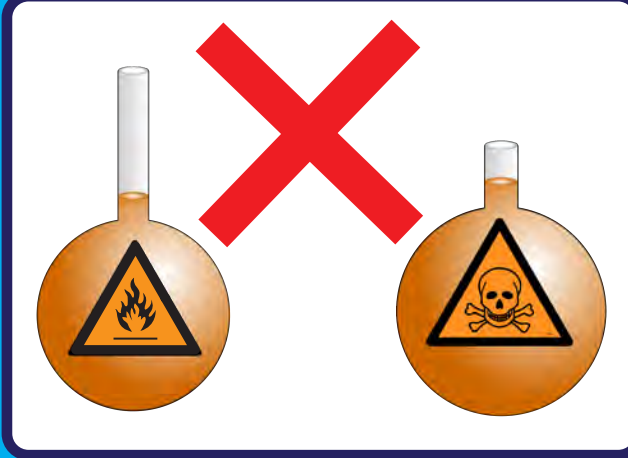

The suitability of this cabinet for your application should be ascertained by an industrial hygienist or your safety officers. DO NOT use this cabinet with any toxic, flammable or explosive materials.

DO NOT OPERATE THE CABINET IF ANY OF THE ALARMS ARE ACTIVATED



Call your Local Representative for immediate service.

A BUNSEN BURNER SHOULD NOT BE USED



The resulting buoyancy effects will affect cabinet airflow and containment. When absolutely necessary, low pilot light type electric burners may be used.

DO NOT USE THE CABINET AS A STORAGE AREA

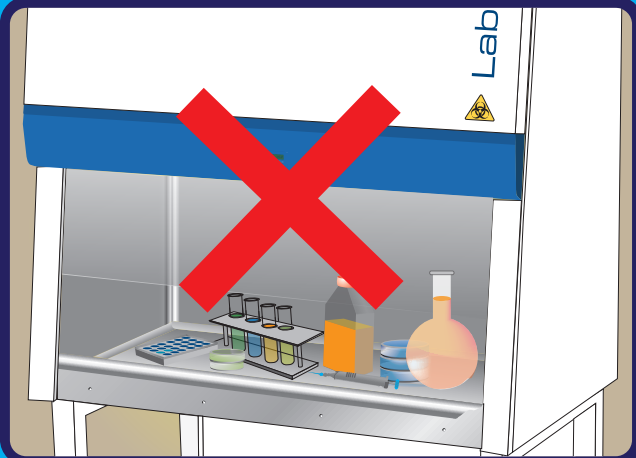

Overloading the cabinet with unnecessary items can affect cabinet airflow and containment.

PROPER CABINET LOCATION IS CRITICAL

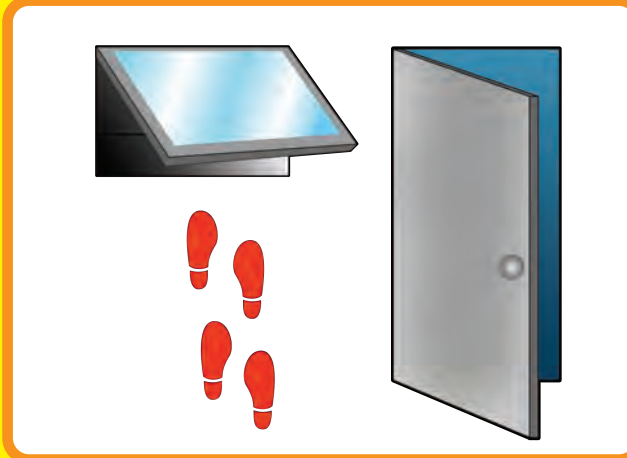

External airflow disturbances (doors, excessive human traffic, windows, diffusers, air conditioner outlets) can compromise containment.

ALWAYS OPERATE THE UNIT CONTINUOUSLY



To maintain the airflow barrier and prevent contaminants from escaping.

MINIMIZE DISTURBANCES TO AIRFLOW BARRIER



Work in a controlled and steady manner, avoiding rapid movements.

THE CABINET MUST BE CERTIFIED ANNUALLY



This ensures cabinet airflows and containment factors are within safe limits. The cabinet should also be re-certified if it is physically relocated to ensure no filter damage has occurred.

OBSERVE SURFACE-DECONTAMINATION

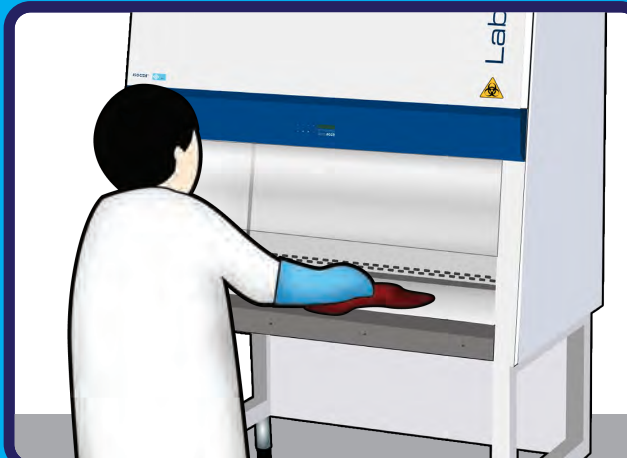

Decontaminate work zone with cleaning agents after every use. Germicidal UV-lamps are not a substitute for good cleaning practices.

ALLOW FOR PURGE CYCLES

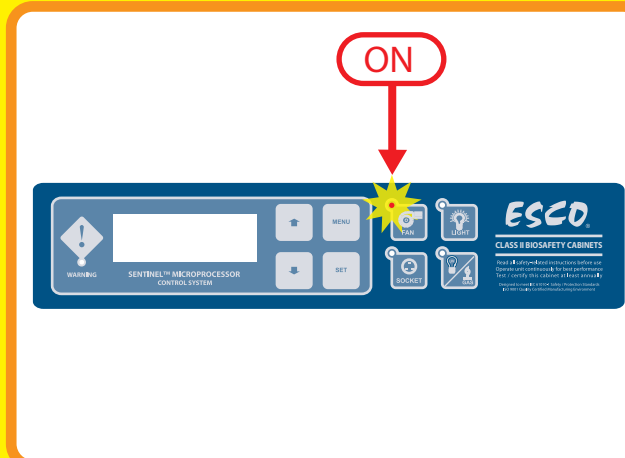

Leave the blower on before & after use so as to purge the work zone of any contaminants.

OBSERVE CORRECT SASH OPENING HEIGHT



Always set the sash to the work height when working in the cabinet.

ONLY TRAINED PERSONNEL SHOULD USE THE CABINET

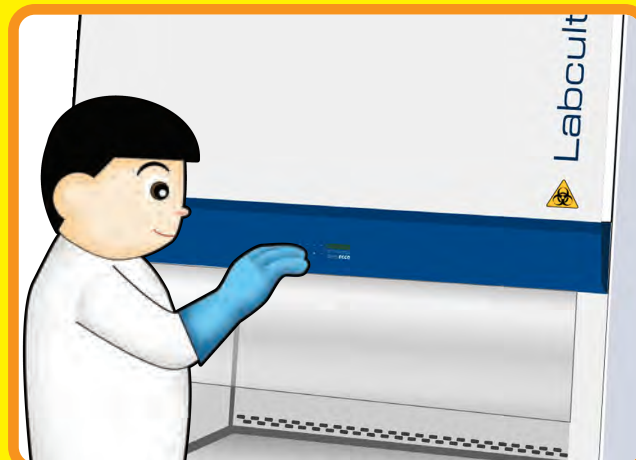

Access control provisions (key switch and/or password protection feature) are standard features on most Esco cabinets.

PROPER WORK ATTIRE



Wearing a back-fastened lab coat (to protect the operator from splashes) as well as double gloving (over the cuffs) should be practiced.

WORK WITHIN THE SAFE AREAS



DO NOT obstruct any of the air grilles in the front or back of the work zone. Work as deep into the work zone as possible.

OBSERVE PROPER ASEPTIC TECHNIQUE



Plan your work before starting and place all items inside the cabinet before use (this avoids having to take your arms out from the work zone which disturbs the air barrier). Always work from "clean" to "dirty", segregating contaminated and non-contaminated materials.

NB: Additional reference materials on safe working practices are available from Esco. In addition, we conduct regular training seminars around the world. Please contact us for more information or visit <http://www.escoglobal.com>

ESCO

WORLD CLASS. WORLDWIDE.

Esco Technologies, Inc. • 2940 Turnpike Drive, Units 15-16 • Hatboro, PA 19040, USA and Canada 877-479-ESCO • Tel 215-441-9661 • Fax 215-441-9660 • www.us.escoglobal.com • usa@escoglobal.com

Esco Micro Pte. Ltd. • 21 Changi South Street 1 • Singapore 486 777 • Tel +65 6542 0833 • Fax +65 6542 6920 • mail@escoglobal.com • www.escoglobal.com

Esco Global Offices | Kuala Lumpur, Malaysia | Leiden, The Netherlands | Manama, Bahrain | Mumbai, India | Philadelphia, USA | Salisbury, UK | Shanghai, China | Singapore